

Installation Instructions for Key in Lever Lockset



1. Install Latch into standard tubular door prep, 2-1/8" main bore hole, 1" edge bore hole, backset 2-3/8" (standard) or 2-3/4" (on request).

2. Facing the outside lever assembly, turn the rosette 3 complete turns going in the counter clockwise direction. Be careful not to run rosette against the lever. This will cause the inner housing to extend out from the rosette.

3. Install outside lever and rosette assembly, inserting square spindle through latch.

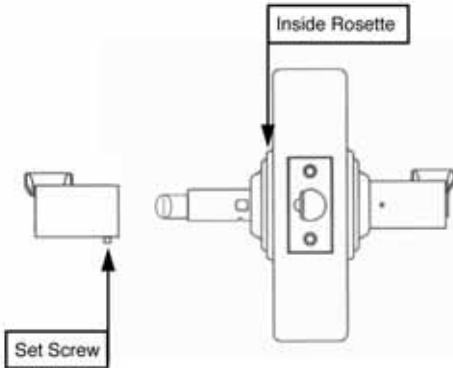
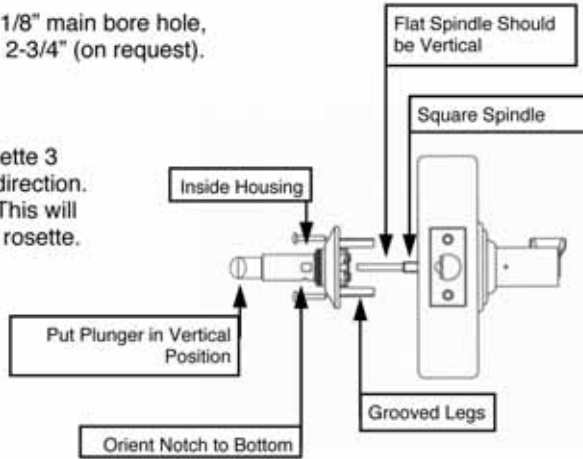

4. Install inside housing, mating grooved legs into outside housing. Put plunger in horizontal position and, if necessary, rock back and forth until spindle slips all the way into the inside housing.

5. Thread inside rosette into inside housing. Tighten both inside and outside rosettes finger tight against door.

6. Fit inside lever onto housing, tighten set screw on bottom.

Removing Cylinder - only necessary if cylinder is being re-pinned

Turn key to horizontal position. Insert wire into small hole and separate lever from rosette. Now the cylinder can be removed through the back of the lever.

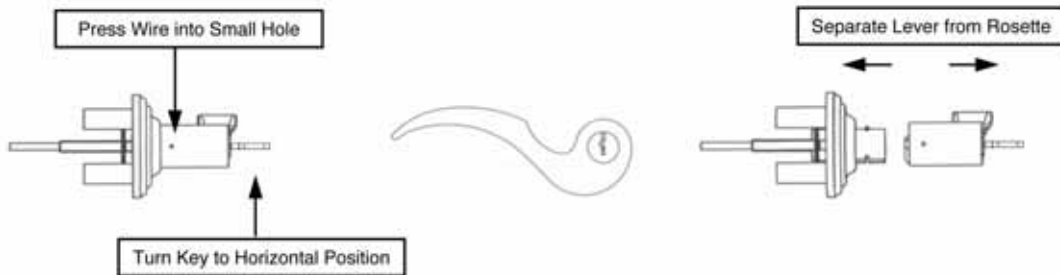

EMTEK
ASSA ABLOY

DA-KY353X

REV. 11/04/01

Installation Instructions-Key in Lever w/ #8 Style Rosette



Door Prep

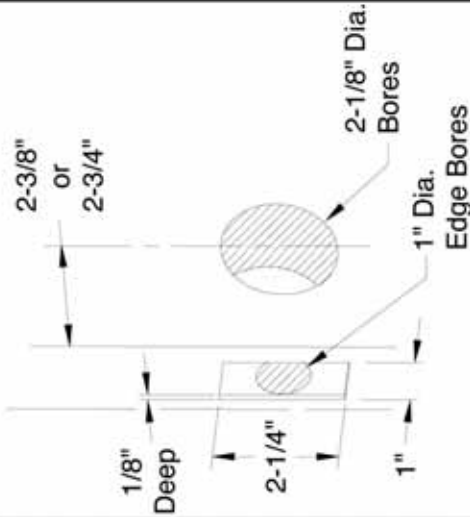

Lock Assembly

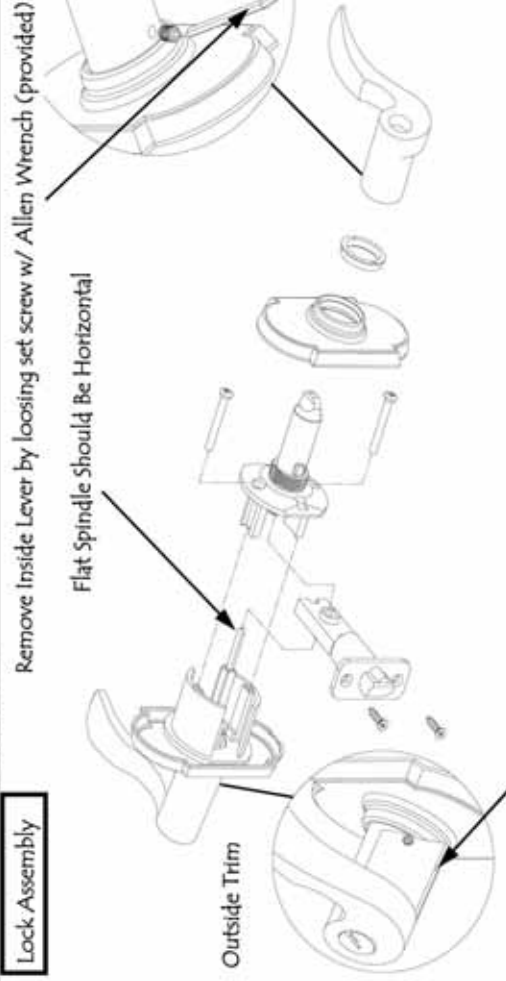

NOTE: Levers vary depending on style.

Remove Rosette

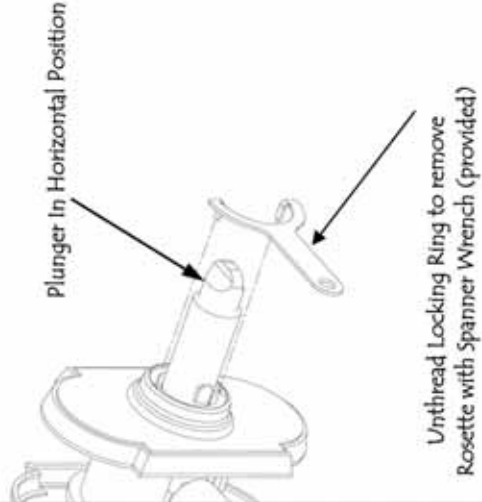

Inside Trim

Secure Inside Rosette by threading The Locking Ring into Place with Spanner Wrench (provided)

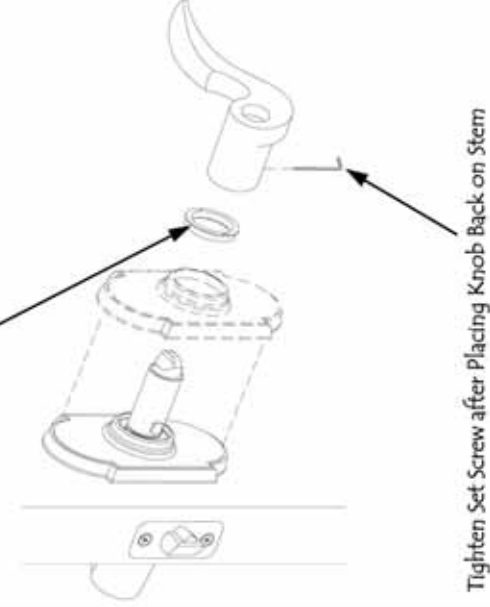

Re-Pinning Cylinder

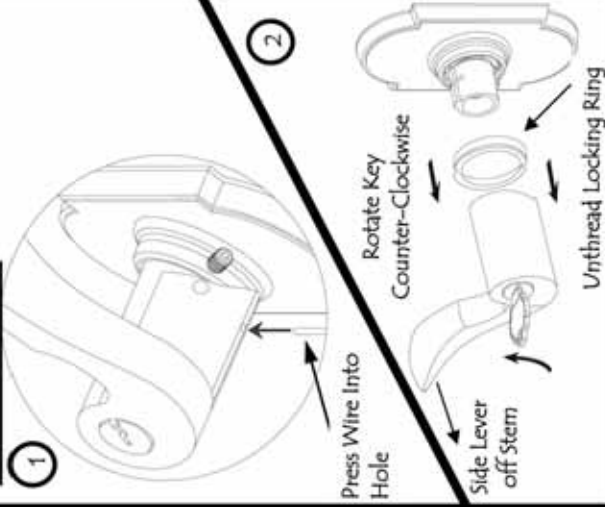

Installation Instructions for Dummy Key in Lever Lockset



1. Unpack the lock and loosen the set screws at the bottom of each Lever. Remove Levers from Inner Housing and unthread the Rosettes from Inner Housings.
2. Install inner housings onto surface of door orienting the notch on the housing to the bottom. The two wood screws should be located at the top and bottom.
3. Thread the Rosettes into the Inner Housings and slip Levers into Inner Housings. Tighten the set screws at the bottom of each Lever.

